

# HOUSING

## RETRO FAMIGAME

### SYSTEM

# ASSEMBLING GUIDE

---

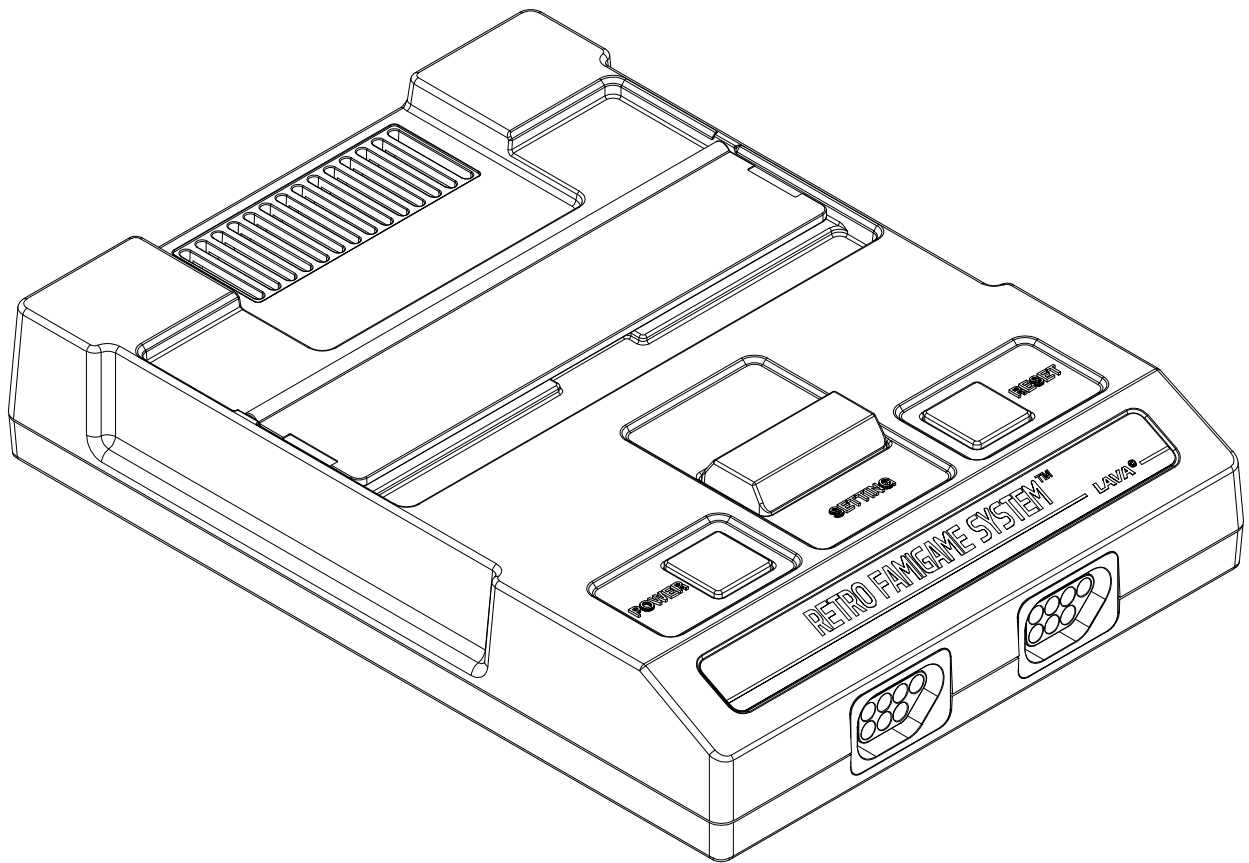

Designed by OS-STUDIO

# NOTICE

Thanks For Purchasing The Retro Fami-Game System Housing. This Housing Set Fits With All LAVA-FC Mother Board. Please Contact OS-STUDIO When You Have Any Question About The Assembly Work. Enjoy Your LAVA Retro Fami-Game System!

# TOOLS REQUIRED

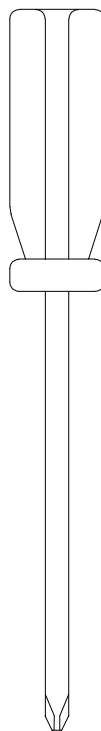

3.5mm  
Cross  
Screwdriver



# CONTENT

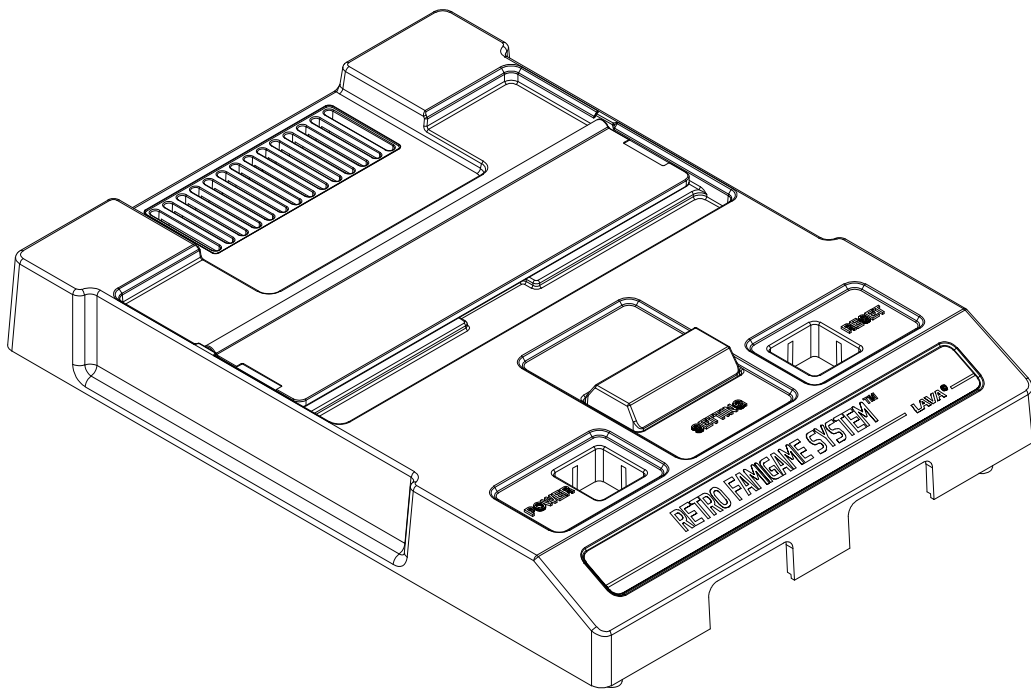

1X

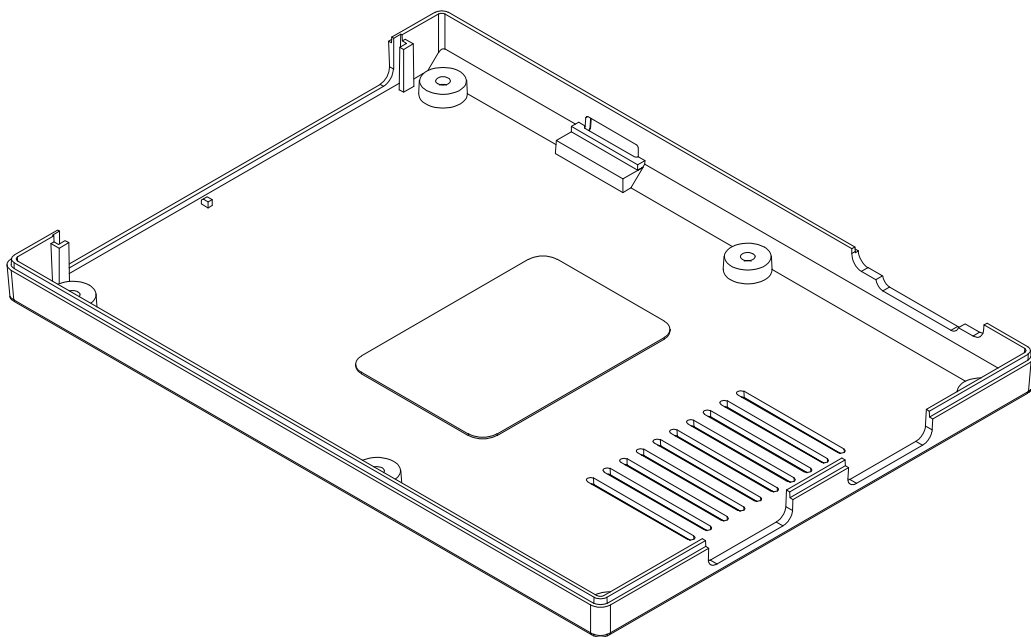

1X

# CONTENT

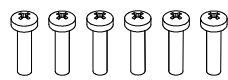

6X

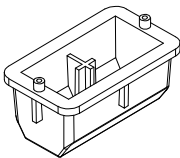

1X

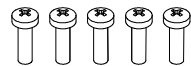

5X

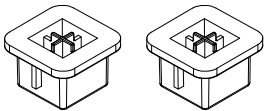

2X

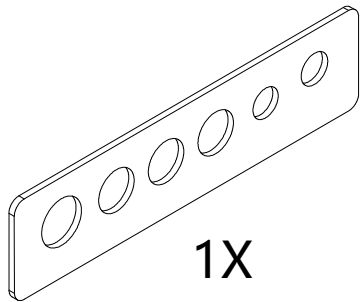

1X

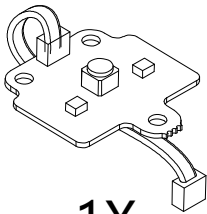

1X

# STEP 1

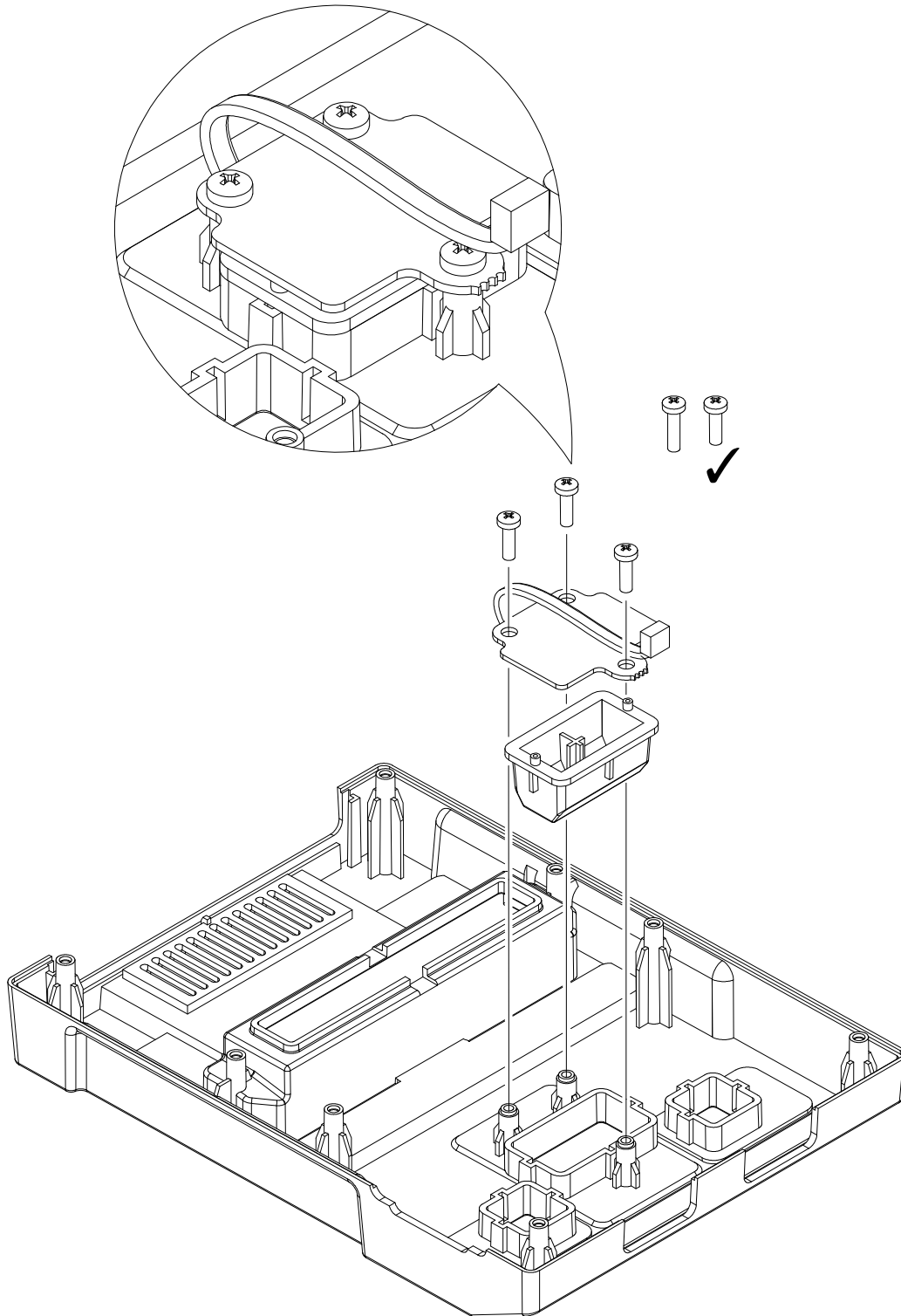

# STEP 2

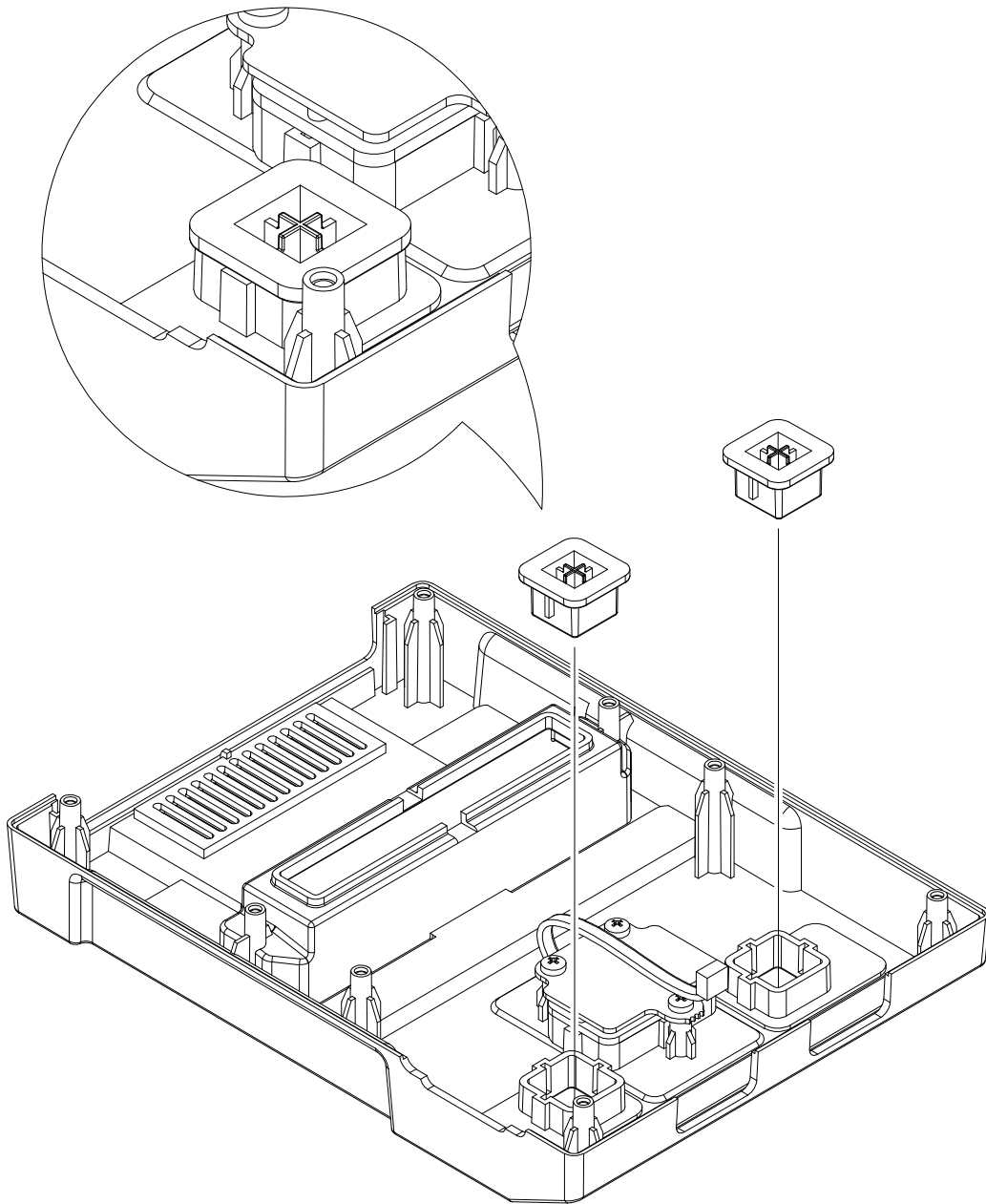

# STEP 3

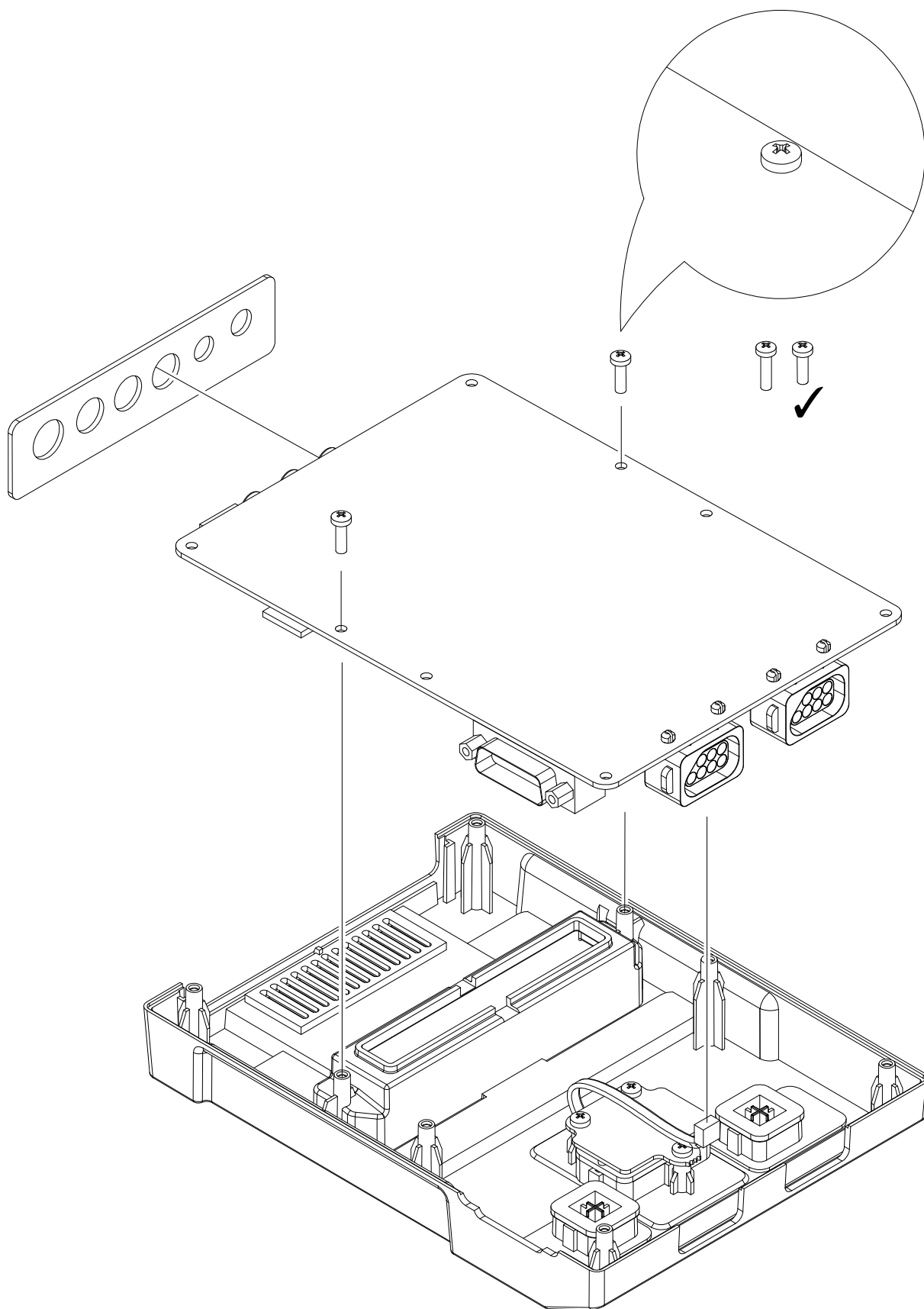



# STEP 4

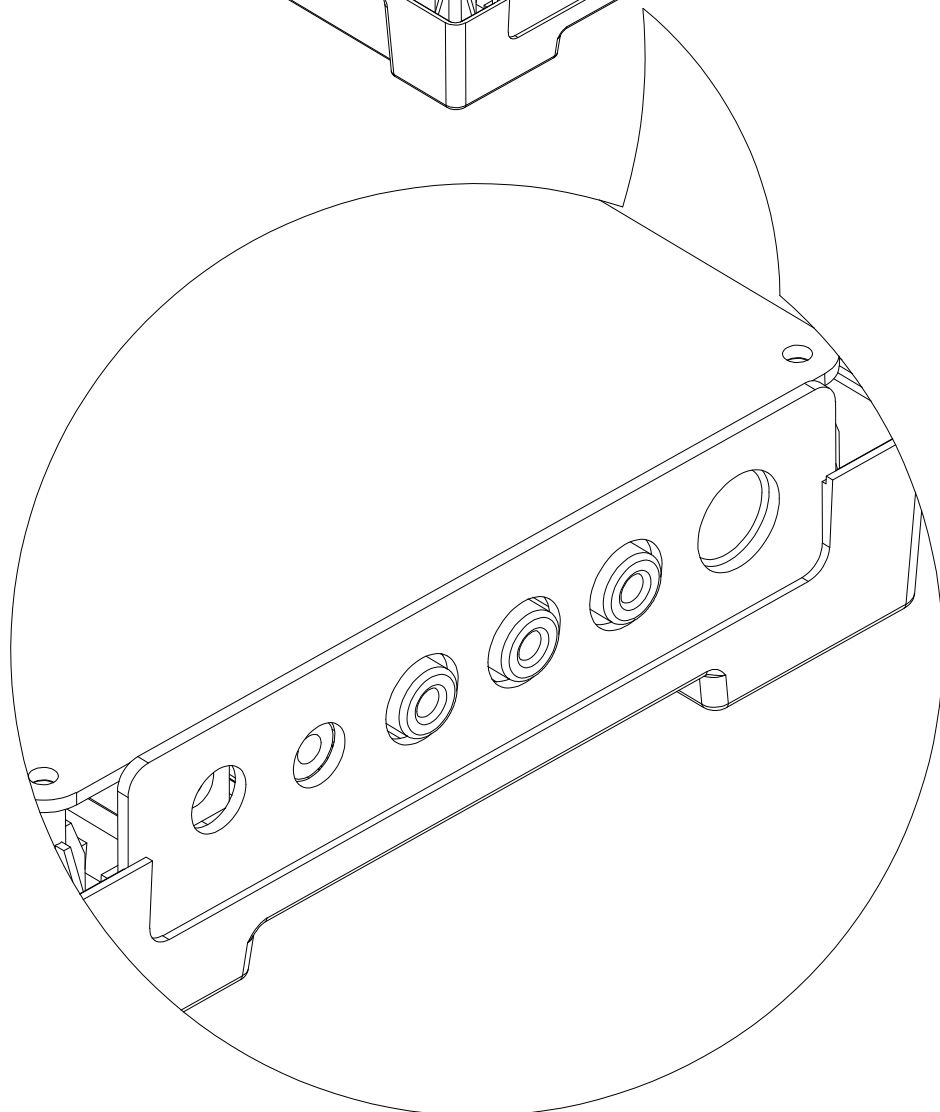
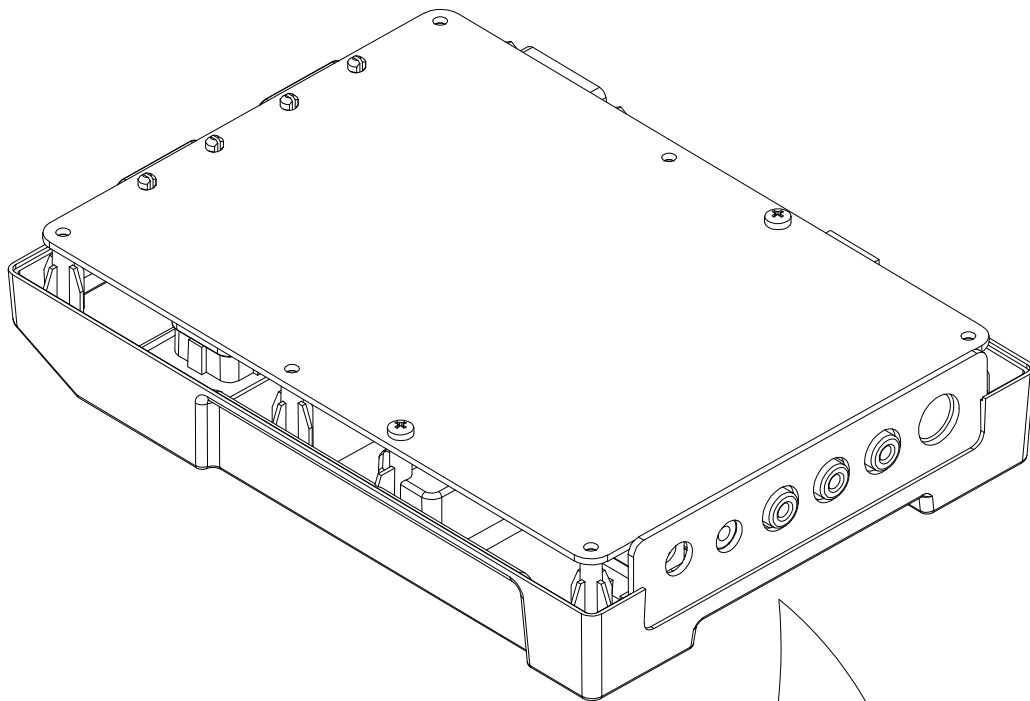

# STEP 5

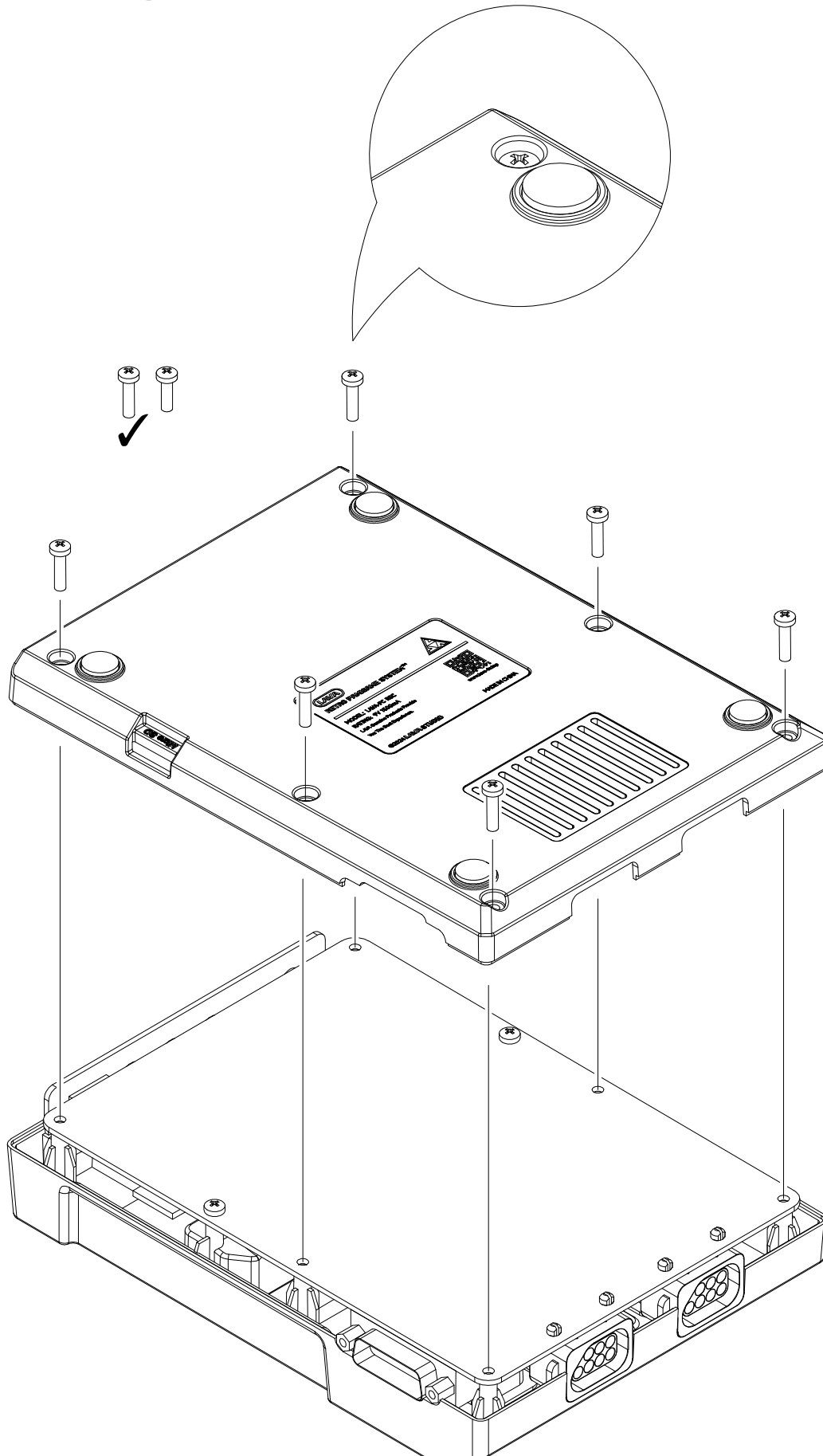

# FINISHED

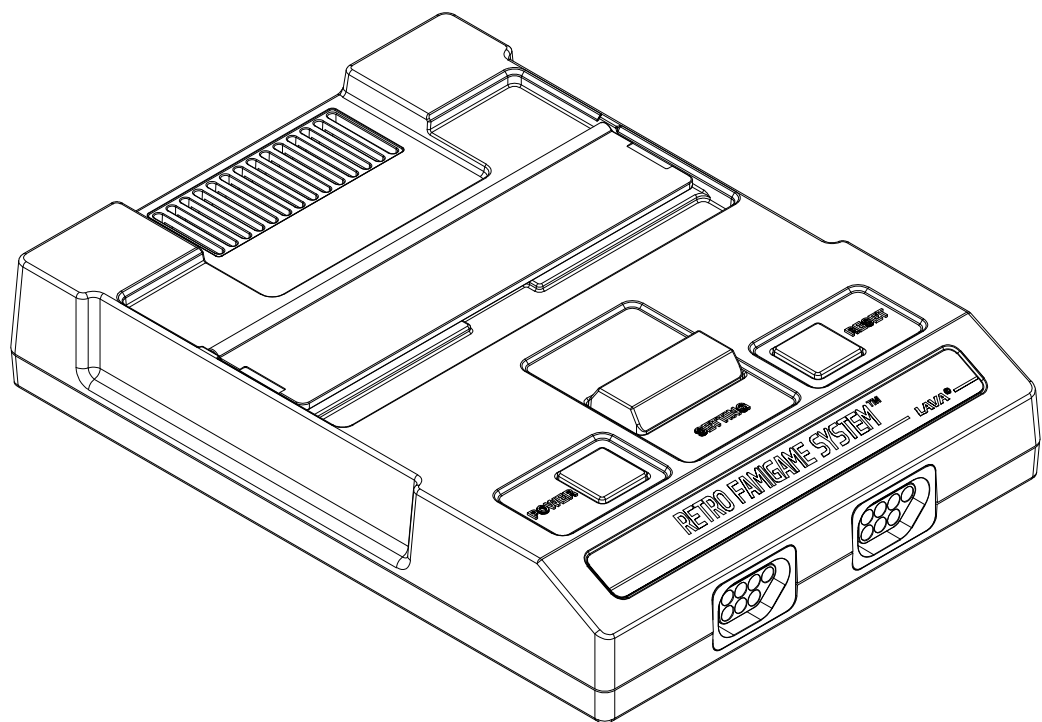
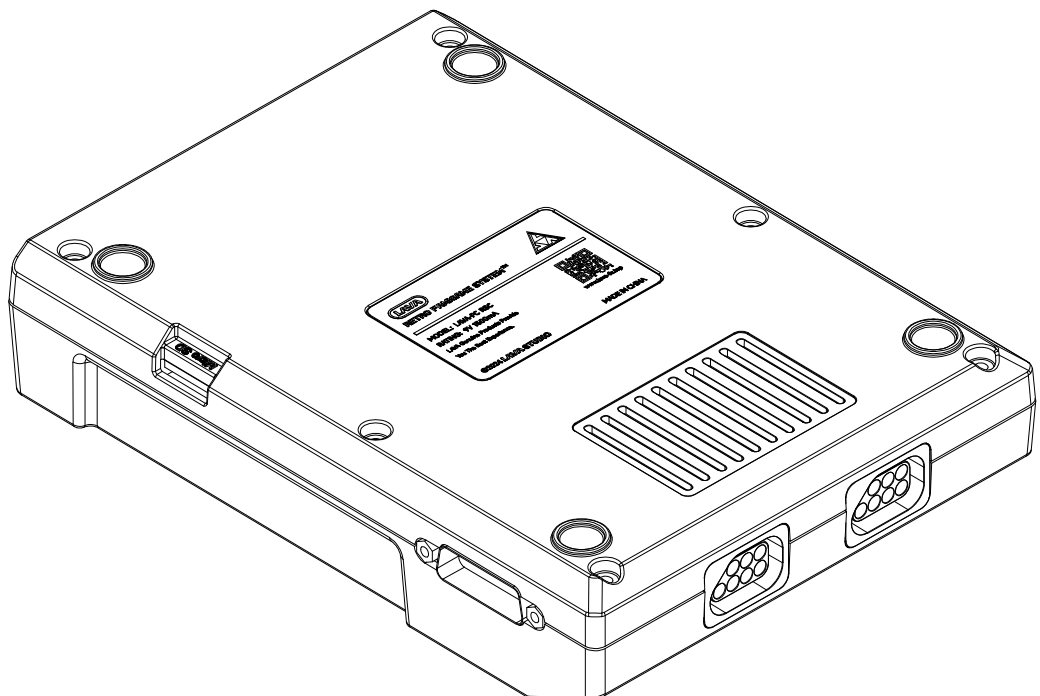

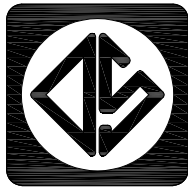

Designed by OS-STUDIO

REV 1.1

©2024 OS-STUDIO

All Rights Reserved